

ERISPOL PW

V TYPE ABSOLUTE MINI PLEAT FILTERS

**EFFICIENCY
H13**



TYPICAL APPLICATIONS

Absolute air filtration in ventilation systems:
 Hospitals
 Food industries
 Pharmaceutical industries
 Thanks to the large filtering surface, the polydiagonal filters have a longer clogging time and higher flow rate than standard deep folded filters

TECHNICAL CHARACTERISTICS

MEDIA = Glass fibre paper .

SEPARATORS = Cotton threads with hot melt glueing.

FRAME = Galvanized steel with foldable handle

SEALANT = Two components cold moulded polyurethane.

GASKET = One piece gasket

EFFICIENCY =

CODE	CEN-EN 1822 FILTRATION CLASS			EUROVENT 4/4 FILTRATION CLASS	
	CLASS	Filters global efficiency % for MPPS particles	Local efficiency % for MPPS particles	CLASS	Initial Efficiency Ei %
ST	H13	≥99,95 %	99,95%	EU13	99,99 ≤ Ei < 99,999

TEMPERATURE = 80°C max.

RELATIVE HUMIDITY = 100% max.

TESTING = Each filter supplied with individual test report

ERISPOL PW (ST) STANDARD SIZES

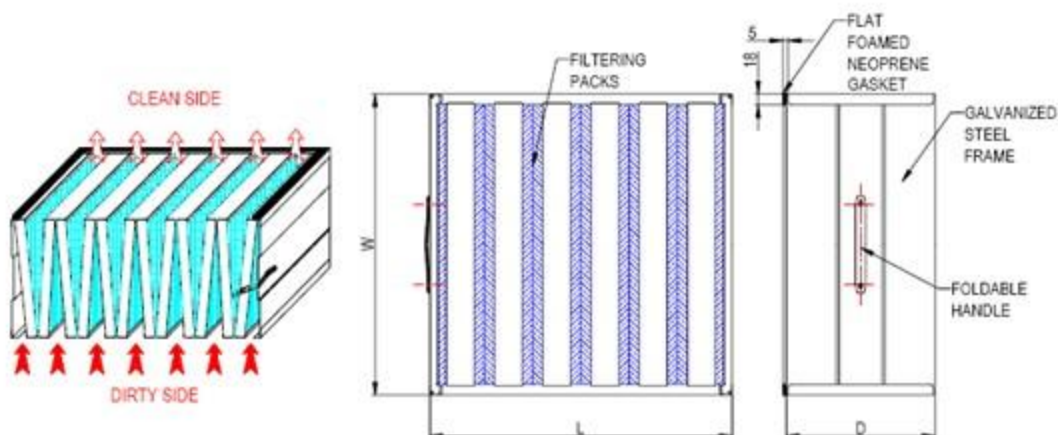

CODE	dimensions W x L x D mm	flow rate m ³ /h	pressure drop Pa	filtering surface m ²	volume m ³	weight kg
PW 11 ST 00	288 X 593 X 292	1800	250	20,0	0,055	11,50
PW 13 ST 00	490 X 593 X 292	2700	250	30,0	0,082	16,50
PW 14 ST 00	593 X 593 X 292	3600	250	40,0	0,110	20,50

Pressure drop as a function of the air flow rate

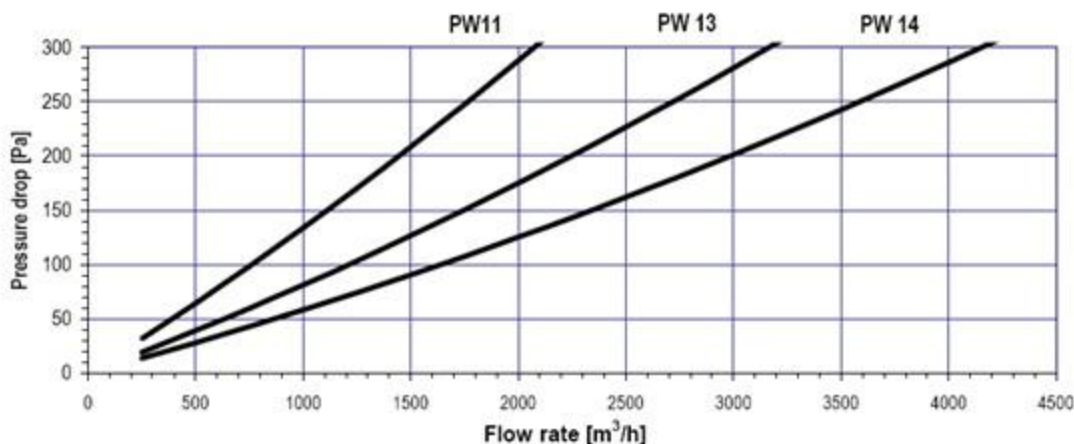

Recommended final pressure drop ≤ 600 Pa

Burst pressure ≤ 1000 Pa